

# RBS181-563K Datasheet

[www.digi-electronics.com](http://www.digi-electronics.com)



<https://www.DiGi-Electronics.com>

DiGi Electronics Part Number	RBS181-563K-DG
Manufacturer	<a href="#">Allied Components International</a>
Manufacturer Product Number	RBS181-563K
Description	56MH, RADIAL LEADED SHIELDED IND
Detailed Description	56 mH Shielded Inductor 12 mA 58mOhm Max Radial, Vertical Cylinder



Tel: +00 852-30501935

RFQ Email: [Info@DiGi-Electronics.com](mailto:Info@DiGi-Electronics.com)

DiGi is a global authorized distributor of electronic components.

## Purchase and inquiry

Manufacturer Product Number:

RBS181-563K

Series:

-

Type:

-

Inductance:

56 mH

Current Rating (Amps):

12 mA

Shielding:

Shielded

Q @ Freq:

100 @ 50kHz

Ratings:

-

Inductance Frequency - Test:

50 kHz

Mounting Type:

Through Hole

Supplier Device Package:

Radial

Height - Seated (Max):

0.413" (10.50mm)

Manufacturer:

Allied Components International

Product Status:

Active

Material - Core:

-

Tolerance:

±10%

Current - Saturation (Isat):

-

DC Resistance (DCR):

58mOhm Max

Frequency - Self Resonant:

120kHz

Operating Temperature:

-55°C ~ 105°C

Features:

-

Package / Case:

Radial, Vertical Cylinder

Size / Dimension:

0.413" Dia (10.50mm)

## Environmental & Export classification

RoHS Status:

ROHS3 Compliant

REACH Status:

REACH info available upon request

HTSUS:

8504.50.4000

Moisture Sensitivity Level (MSL):

1 (Unlimited)

ECCN:

EAR99





## Radial Leaded Shielded Inductor

RBS181

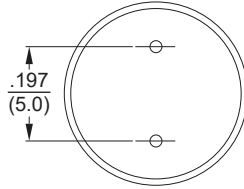
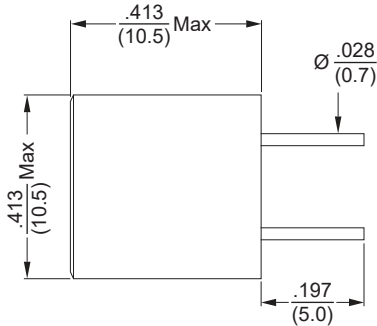
Dimensions:  $\frac{\text{inch}}{\text{mm}}$ 

Allied Part Number	Inductance (mH)	Tolerance ( $\pm\%$ )*	Q Min.	Q Test Freq (KHz)	SRF Min. (MHz)	DCR Max ( $\Omega$ ).	IDC (mA)
RBS181-102_	1.0	J,K	70	50	0.77	3.4	90
RBS181-122_	1.2	J,K	70	50	0.70	3.7	75
RBS181-152_	1.5	J,K	70	50	0.64	4.0	70
RBS181-182_	1.8	J,K	70	50	0.57	4.5	65
RBS181-222_	2.2	J,K	70	50	0.51	5.2	60
RBS181-272_	2.7	J,K	70	50	0.48	5.8	55
RBS181-332_	3.3	J,K	100	50	0.44	6.1	50
RBS181-392_	3.9	J,K	100	50	0.41	7.2	45
RBS181-472_	4.7	J,K	100	50	0.38	7.5	40
RBS181-562_	5.6	J,K	100	50	0.35	8.4	40
RBS181-682_	6.8	J,K	100	50	0.32	9.7	35
RBS181-822_	8.2	J,K	100	50	0.28	10.4	30
RBS181-103_	10	J,K	100	50	0.25	12.1	25
RBS181-123_	12	J,K	100	50	0.22	13.0	25
RBS181-153_	15	J,K	100	50	0.22	15.0	20
RBS181-183_	18	J,K	100	50	0.19	17.0	22
RBS181-223_	22	J,K	100	50	0.19	19.5	21
RBS181-273_	27	J,K	100	50	0.16	22.0	18
RBS181-333_	33	J,K	100	50	0.16	26.0	17
RBS181-363_	36	J,K	100	50	0.14	27.0	16
RBS181-393_	39	J,K	100	50	0.12	45.0	15
RBS181-473_	47	J,K	100	50	0.12	52.0	13
RBS181-563_	56	J,K	100	50	0.12	58.0	12
RBS181-683_	68	J,K	100	50	0.09	67.0	11
RBS181-823_	82	J,K	100	50	0.09	71.0	10
RBS181-104_	100	J,K	100	50	0.09	82.0	9
RBS181-124_	120	J,K	100	50	0.08	97.0	8

\*Insert letter at the end of the part number for desired tolerance J=5%, K=10%  
All specifications subject to change without notice

Features

- For R.F. and other applications
- Magnetically Shielded Construction
- Extensive Inductance Range
- RoHS Compliance

Electrical

**Inductance Range:** 1.0mH - 120mH  
**Tolerance:** \*Available in 5% and 10% as indicated  
**Test Frequency:** (L) @1KHZ, Q @ 50KHZ  
**Operating Temperature:** -55°C to +105°C  
**Rated Current:** The current at which the inductance will decrease by no more than 10% from initial value without current

Test Equipment

**Inductance:** HP4342A & HP4284A  
**DCR:** CH-301 Current Source & DCR Meter  
**Current:** CH-301 Current Source & DCR Meter

Physical

**Packaging:** 400/Tray  
**Marking:** EIA Inductance code

## OUR CERTIFICATE

DiGi provide top-quality products and perfect service for customer worldwide through standardization, technological innovation and continuous improvement. DiGi through third-party certification, we strictly control the quality of products and services. Welcome your RFQ to

Email: [Info@DiGi-Electronics.com](mailto:Info@DiGi-Electronics.com)



Tel: +00 852-30501935

RFQ Email: [Info@DiGi-Electronics.com](mailto:Info@DiGi-Electronics.com)

DiGi is a global authorized distributor of electronic components.