

CDMPIH60D28NP-2R2PC Datasheet



DiGi Electronics Part Number	CDMPIH60D28NP-2R2PC-DG
Manufacturer	Sumida America Components Inc.
Manufacturer Product Number	CDMPIH60D28NP-2R2PC
Description	INDUCTOR
Detailed Description	2.2 μ H Shielded Drum Core, Wirewound Inductor 2.7 A 42mOhm Max Nonstandard

<https://www.DiGi-Electronics.com>



Tel: +00 852-30501935

RFQ Email: Info@DiGi-Electronics.com

DiGi is a global authorized distributor of electronic components.

Purchase and inquiry

Manufacturer Product Number:

CDMPIH60D28NP-2R2PC

Series:

CDMPIH60D28

Type:

Drum Core, Wirewound

Inductance:

2.2 μ H

Current Rating (Amps):

2.7 A

Shielding:

Shielded

Q @ Freq:

-

Ratings:

-

Inductance Frequency - Test:

100 kHz

Mounting Type:

Surface Mount

Supplier Device Package:

-

Height - Seated (Max):

0.118" (3.00mm)

Manufacturer:

Sumida America Components Inc.

Product Status:

Active

Material - Core:

Ferrite

Tolerance:

\pm 25%

Current - Saturation (Isat):

4.3A

DC Resistance (DCR):

42mOhm Max

Frequency - Self Resonant:

-

Operating Temperature:

-40°C ~ 105°C

Features:

-

Package / Case:

Nonstandard

Size / Dimension:

0.260" L x 0.244" W (6.60mm x 6.20mm)

Environmental & Export classification

Moisture Sensitivity Level (MSL):

1 (Unlimited)

SMD Power Inductor

CDMPIH60D28



Description

- Ferrite core construction.
- Magnetically shielded .
- Lower flux leakage.
- L × W × H: 6.6 × 6.2 × 3.0 mm Max.
- Product weight:0.39 g (Ref.)
- Moisture Sensivity Level: 1
- RoHS compliance.

Dimension - [mm]

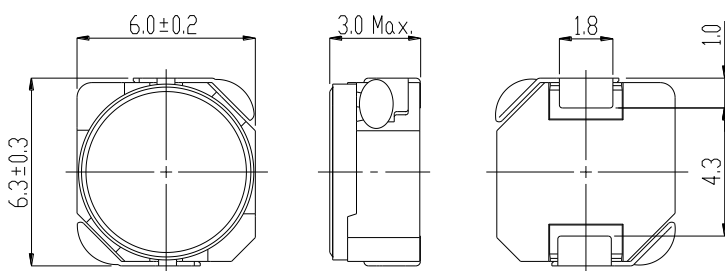

Land pattern and Schematics - [mm]

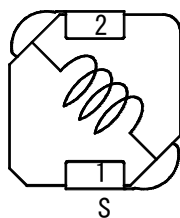
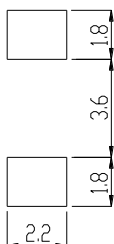

Environmental Data

- Operating temperature range: -40°C~+105°C (including coil's self temperature rise)
- Storage temperature range: -40°C~+105°C
- Solder reflow temperature: 260 °C peak.

Packaging

- Carrier tape and reel packaging.
- 13.0" diameter reel
- 1500pcs per reel

Applications

- Ideally used in filter choke of camera lens etc.

SMD Power Inductor

CDMPIH60D28

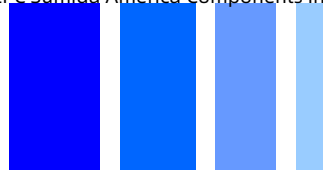

Electrical Characteristics

Part No.	Stamp	Inductance (μH) [Within] ※1	D.C.R.(m Ω) [Within] (at 20°C)	Saturation current (A)※3		Temperature rise current (A) ※4
				(at 20°C)	(at 105°C)	
CDMPIH60D28NP-2R2PC	2R2	2.2±25%	42(33)	5.20	4.30	2.70
CDMPIH60D28NP-3R6PC	3R6	3.6±25%	52(42)	4.10	3.40	2.40
CDMPIH60D28NP-4R3PC	4R3	4.3±25%	56(45)	3.70	3.00	2.35
CDMPIH60D28NP-6R8PC	6R8	6.8±25%	85(68)	2.85	2.30	1.85
CDMPIH60D28NP-100MC	100	10±20%	130(105)	2.40	2.00	1.45
CDMPIH60D28NP-150MC	150	15±20%	200(160)	2.00	1.60	1.15
CDMPIH60D28NP-220MC	220	22±20%	293(234)	1.60	1.30	0.90
CDMPIH60D28NP-330MC	330	33±20%	412(330)	1.30	1.10	0.75

※1. Measuring condition: at 100kHz.

※2. Saturation current: The value of D.C. current when the inductance decreases to 65% of it's nominal value.

※3. Temperature rise current: The actual value of D.C. current when the temperature rise is $\Delta t=40^\circ\text{C}$ ($T_a=20^\circ\text{C}$).

Saturation Current & Temperature Rise Graph

— L (20°C) — L (105°C) — ΔT

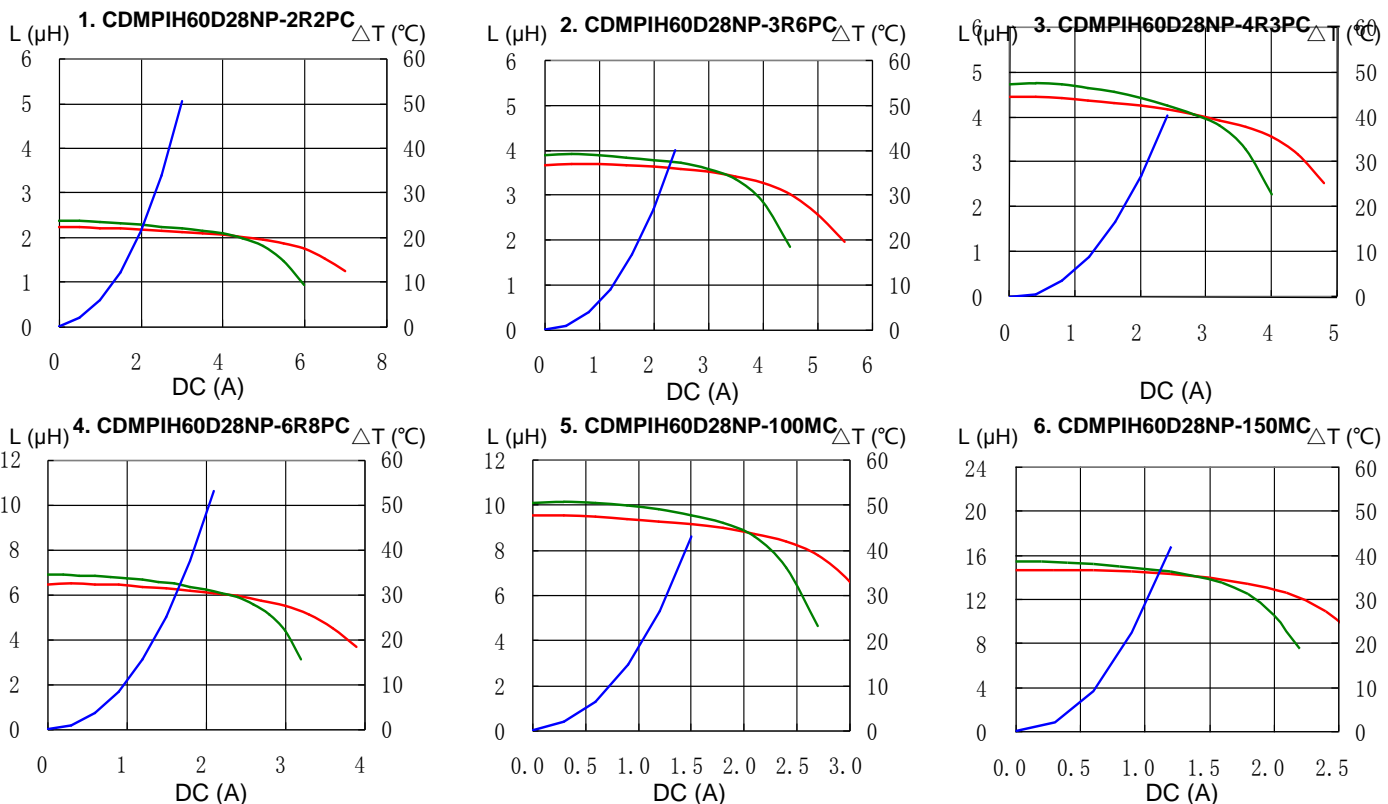

SMD Power Inductor CDMPIH60D28

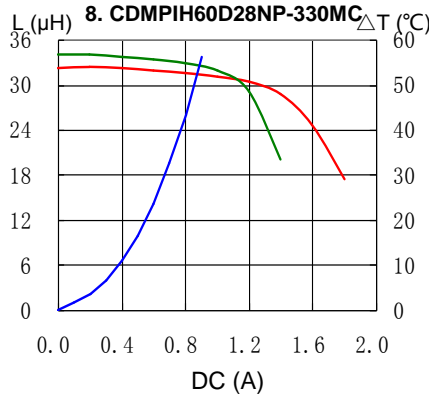
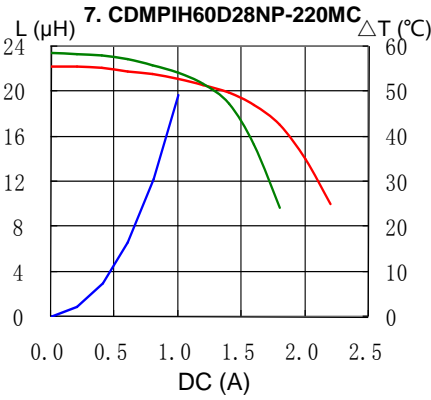
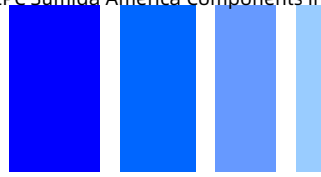

Solder Reflow Condition

Heat Endurance

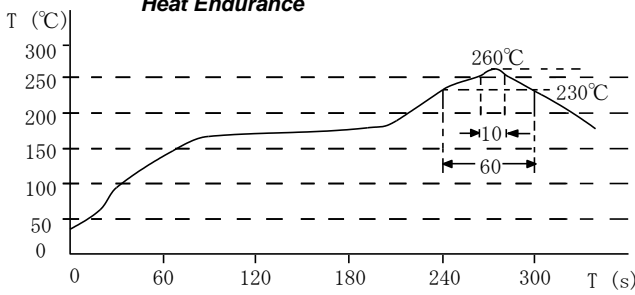

Temperature Chart

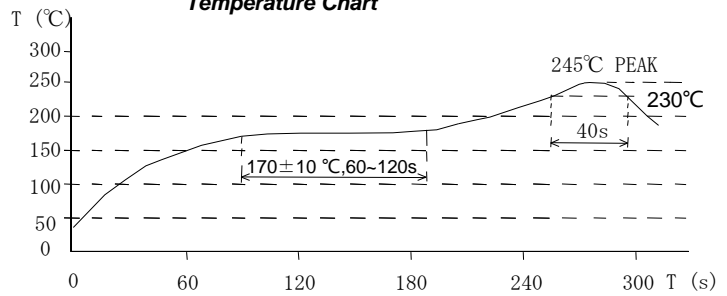

Please refer to the sales offices on our website - <http://www.sumida.com>

Hong Kong

Tel.+852-2880-6781
FAX.+852-2565-9600
sales@hk.sumida.com

Saitama(Japan)

Tel.+81-48-691-7300
FAX.+81-48-691-7340
sales@jp.sumida.com

Chicago

Tel.+1-847-545-6700
FAX. +1-847-545-6720
sales@us.sumida.com

Shanghai

Tel.+86-21-5836-3299
FAX.+86-21-5836-3266
shanghai.sales@cn.sumida.com

Seoul

Tel.+82-2-6237-0777
FAX.+82-2-6237-0778
sales@kr.sumida.com

Obernzell

Tel.+49-8591-937-0
FAX. +49-8591-937-103
contact@eu.sumida.com

Shenzhen

Tel.+86-755-8291-0228
FAX.+86-755-8291-0338
shenzhen.sales@cn.sumida.com

Singapore

Tel.+65-6296-3388
FAX.+65-6841-4426
sales@sg.sumida.com

Neumarkt

Tel.+49-9181-4509-110
FAX. +49-9181-4509-310
infocomp@eu.sumida.com

Taipei

Tel.+886-2-8751-2737
FAX.+886-2-8751-2738
sales@tw.sumida.com

San Jose

Tel.+1-408-321-9660
FAX.+1-408-321-9308
sales@us.sumida.com

OUR CERTIFICATE

DiGi provide top-quality products and perfect service for customer worldwide through standardization, technological innovation and continuous improvement. DiGi through third-party certification, we stricly control the quality of products and services. Welcome your RFQ to

Email: Info@DiGi-Electronics.com



Tel: +00 852-30501935

RFQ Email: Info@DiGi-Electronics.com

DiGi is a global authorized distributor of electronic components.