

# SMF40A-M3-08 Datasheet

[www.digi-electronics.com](http://www.digi-electronics.com)

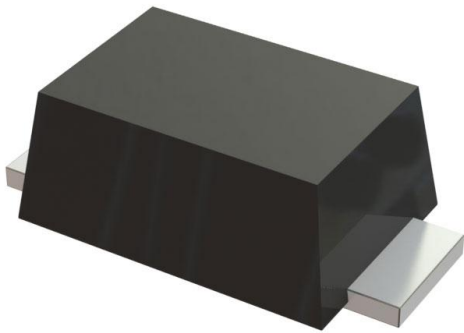

<https://www.DiGi-Electronics.com>

DiGi Electronics Part Number	SMF40A-M3-08-DG
Manufacturer	<a href="#">Vishay General Semiconductor - Diodes Division</a>
Manufacturer Product Number	SMF40A-M3-08
Description	TVS DIODE 40VWM 64.5VC SMF
Detailed Description	64.5V Clamp 3.1A Ipp Tvs Diode Surface Mount DO-219AB (SMF)

This model SMF40A-M3-08 is available at DiGi Electronics.

DiGi Electronics offers a global database of semiconductor and electronic component datasheets.

We welcome your inquiries regarding pricing, lead time, or other product-related questions.

 [Request a Quote](#)

 [Datasheet Search](#)



Tel: +00 852-30501935

RFQ Email: [Info@DiGi-Electronics.com](mailto:Info@DiGi-Electronics.com)

DiGi is a global authorized distributor of electronic components.

## Purchase and inquiry

Manufacturer Product Number:

SMF40A-M3-08

Series:

eSMP®

Type:

Zener

Voltage - Reverse Standoff (Typ):

40V

Voltage - Clamping (Max) @ Ipp:

64.5V

Power - Peak Pulse:

200W

Applications:

General Purpose

Operating Temperature:

-65°C ~ 175°C (Tj)

Package / Case:

DO-219AB

Base Product Number:

SMF40

Manufacturer:

Vishay General Semiconductor - Diodes Division

Product Status:

Active

Unidirectional Channels:

1

Voltage - Breakdown (Min):

44.4V

Current - Peak Pulse (10/1000µs):

3.1A

Power Line Protection:

No

Capacitance @ Frequency:

172pF @ 1MHz

Mounting Type:

Surface Mount

Supplier Device Package:

DO-219AB (SMF)

## Environmental & Export classification

RoHS Status:

ROHS3 Compliant

REACH Status:

REACH Unaffected

HTSUS:

8541.10.0080

Moisture Sensitivity Level (MSL):

1 (Unlimited)

ECCN:

EAR99

[www.vishay.com](http://www.vishay.com)

# SMF5V0A to SMF58A

Vishay Semiconductors

## Surface-Mount ESD Protection Diodes

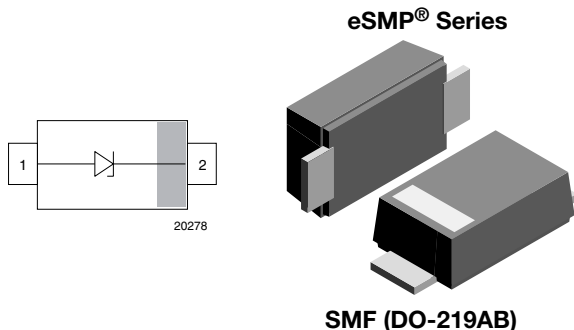

**RoHS**  
COMPLIANT

### FEATURES

- 200 W peak pulse power capability with a 10/1000  $\mu$ s waveform, repetition rate (duty cycle): 0.01 %
- Low profile package
- Wave and reflow solderable
- ESD immunity acc. IEC 61000-4-2  $\pm$  30 kV contact discharge  $\pm$  30 kV air discharge
- ESD capability according to AEC-Q101: human body model: class H3B: > 8 kV
- Low incremental surge resistance, excellent clamping capability
- “Low Noise” technology - very fast response time
- AEC-Q101 qualified available
- Compatible to SOD-123W package case outline or SOD-123F and SOD-123FL
- Material categorization: for definitions of compliance please see [www.vishay.com/doc?99912](http://www.vishay.com/doc?99912)

### MARKING (example only)

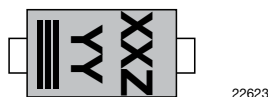

Bar = cathode marking  
 YY = type code (see table below)  
 XX = date code  
 Z = location code (optional)

### LINKS TO ADDITIONAL RESOURCES



ORDERING INFORMATION							
PART NUMBER (EXAMPLE)	ENVIRONMENTAL AND QUALITY CODE			REVISION CODE	PACKAGING CODE		ORDERING CODE (EXAMPLE)
	AEC-Q101 QUALIFIED	RoHS-COMPLIANT + LEAD (Pb)-FREE TERMINATIONS	TIN PLATED		3K PER 7" REEL (8 mm TAPE), MOQ = 30K	10K PER 13" REEL (8 mm TAPE), MOQ = 50K	
SMF5V0A-		E	3	-	08		SMF5V0A-E3-08
SMF5V0A-	H	E	3	_A	08		SMF5V0A-HE3_A08
SMF5V0A-		E	3	-		18	SMF5V0A-E3-18
SMF5V0A-	H	E	3	_A		18	SMF5V0A-HE3_A18

PACKAGE DATA								
PACKAGE NAME	WEIGHT (mg)	HEIGHT MAX. (mm)	LENGTH MAX. (mm)	WIDTH MAX. (mm)	MOLDING COMPOUND FLAMMABILITY RATING	MOISTURE SENSITIVITY LEVEL	WHISKER TEST ACC. JESD 201	SOLDERING CONDITIONS
SMF (DO-219AB)	15	1.08	3.9	1.9	UL 94 V-0	MSL level 1 (acc. J-STD-020)	Class 2	Peak temperature max. 260 °C



ABSOLUTE MAXIMUM RATINGS ( $T_{amb} = 25\text{ }^{\circ}\text{C}$ , unless otherwise specified)				
PARAMETER	TEST CONDITIONS	SYMBOL	VALUE	UNIT
Peak pulse current	$t_p = 10/1000\text{ }\mu\text{s}$ waveform	$I_{PPM}$	see "Electrical Characteristics"	A
Peak pulse power	$t_p = 8/20\text{ }\mu\text{s}$ waveform acc. IEC 61000-4-5	$P_{PP}$	1000	W
	$t_p = 10/1000\text{ }\mu\text{s}$ waveform		200	W
Peak forward surge current	8.3 ms single half sine-wave	$I_{FSM}$	50	A
ESD immunity	Contact discharge acc. IEC 61000-4-2; 10 pulses	$V_{ESD}$	$\pm 30$	kV
	Air discharge acc. IEC 61000-4-2; 10 pulses		$\pm 30$	kV
Thermal resistance	Mounted on epoxy glass PCB with 3 mm x 3 mm, Cu pads ( $\geq 40\text{ }\mu\text{m}$ thick)	$R_{thJA}$	180	K/W
Forward clamping voltage	$I_F = 50\text{A}$ , $t_p = 400\text{ }\mu\text{s}$	$V_F$	2.5	V
Junction temperature		$T_J$	175	$^{\circ}\text{C}$
Storage temperature range		$T_{stg}$	-65 to +175	$^{\circ}\text{C}$
Operating temperature range		$T_{op}$	-65 to +175	$^{\circ}\text{C}$

ELECTRICAL CHARACTERISTICS ( $T_{amb} = 25\text{ }^{\circ}\text{C}$ , unless otherwise specified)										
PART NUMBER	MARKING CODE	REVERSE BREAKDOWN VOLTAGE at $I_T$ , $t_p = 5\text{ ms}$		TEST CURRENT	STAND-OFF VOLTAGE	MAXIMUM REVERSE CURRENT at $V_{RWM}$	MAXIMUM PEAK PULSE CURRENT $t_p = 10/1000\text{ }\mu\text{s}$	MAXIMUM REVERSE CLAMPING VOLTAGE at $I_{PPM}$	TYPICAL CAP. at $V_R = 0\text{ V}$ , $f = 1\text{ MHz}$	PROTECTION PATHS
		$V_{BR}\text{ MIN. (V)}$	$V_{BR}\text{ MAX. (V)}$							
SMF5V0A	AE	6.40	7.1	10	5	5	21.7	9.2	1120	1
SMF6V0A	AG	6.67	7.4	10	6	26	19.4	10.3	1063	1
SMF6V5A	AK	7.22	8	10	6.5	20	17.9	11.2	938	1
SMF7V0A	AM	7.78	8.6	10	7	3	16.7	12	843	1
SMF7V5A	AP	8.33	9.3	1	7.5	0.1	15.5	12.9	773	1
SMF8V0A	AR	8.89	9.9	1	8	0.1	14.7	13.6	706	1
SMF8V5A	AT	9.44	10.5	1	8.5	0.1	13.9	14.4	674	1
SMF9V0A	AV	10	11.2	1	9	0.1	13.5	15.4	640	1
SMF10A	AX	11.1	12.3	1	10	0.1	11.8	17	562	1
SMF11A	AZ	12.2	13.5	1	11	0.1	11	18.2	509	1
SMF12A	BE	13.3	14.7	1	12	0.1	10.1	19.9	483	1
SMF13A	BG	14.4	16	1	13	0.1	9.3	21.5	423	1
SMF14A	BK	15.6	17.3	1	14	0.1	8.6	23.2	392	1
SMF15A	BM	16.7	18.5	1	15	0.1	8.2	24.4	367	1
SMF16A	BP	17.8	19.7	1	16	0.1	7.7	26	343	1
SMF17A	BR	18.9	20.9	1	17	0.1	7.2	27.6	324	1
SMF18A	BT	20	22.3	1	18	0.1	6.8	29.2	320	1
SMF20A	BV	22.2	24.6	1	20	0.1	6.2	32.4	283	1
SMF22A	BX	24.4	27	1	22	0.1	5.6	35.5	271	1
SMF24A	BZ	26.7	29.6	1	24	0.1	5.1	38.9	244	1
SMF26A	CE	28.9	32	1	26	0.1	4.8	42.1	230	1
SMF28A	CG	31.1	34.4	1	28	0.1	4.4	45.4	227	1
SMF30A	CK	33.3	36.9	1	30	0.1	4.1	48.4	207	1
SMF33A	CM	36.7	40.6	1	33	0.1	3.8	53.3	198	1
SMF36A	CP	40	44.3	1	36	0.1	3.4	58.1	178	1
SMF40A	CR	44.4	49.1	1	40	0.1	3.1	64.5	172	1
SMF43A	CT	47.8	52.9	1	43	0.1	2.9	69.4	165	1
SMF45A	CV	50	55.3	1	45	0.1	2.8	72.7	162	1
SMF48A	CX	53.3	59	1	48	0.1	2.6	77.4	161	1
SMF51A	CZ	56.7	62.7	1	51	0.1	2.4	82.4	151	1
SMF54A	CA	60	66	1	54	0.1	2.25	88	148	1
SMF58A	CC	64.4	70.8	1	58	0.1	2.1	95	144	1



**TYPICAL CHARACTERISTICS** ( $T_{amb} = 25\text{ }^{\circ}\text{C}$ , unless otherwise specified)

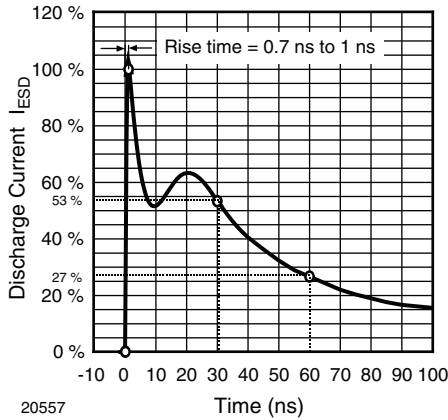

Fig. 1 - ESD Discharge Current Wave Form acc. IEC 61000-4-2 (330  $\Omega$ /150pF)

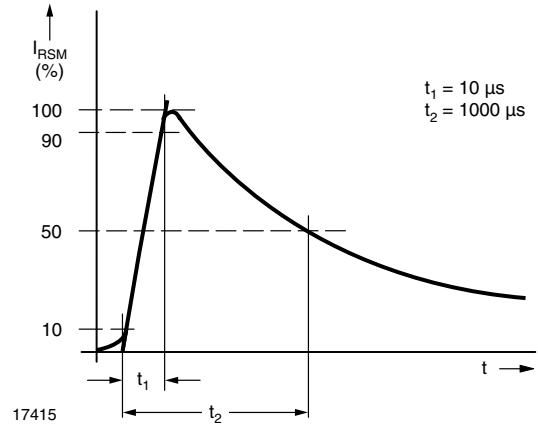

Fig. 4 - Pulse Waveform

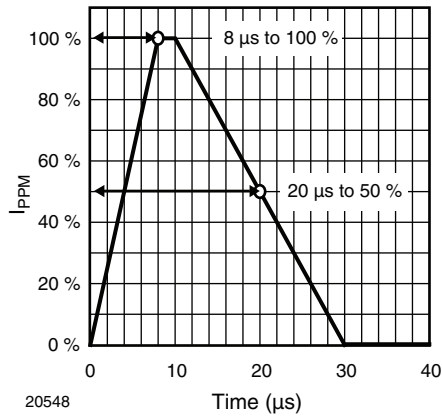

Fig. 2 - 8/20  $\mu\text{s}$  Peak Pulse Current Wave Form acc. IEC 61000-4-5

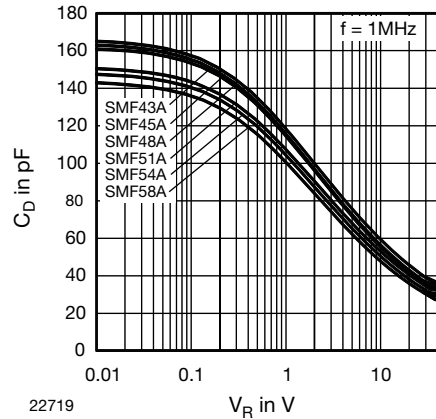

Fig. 5 - Typical Capacitance  $C_D$  vs. Reverse Voltage  $V_R$

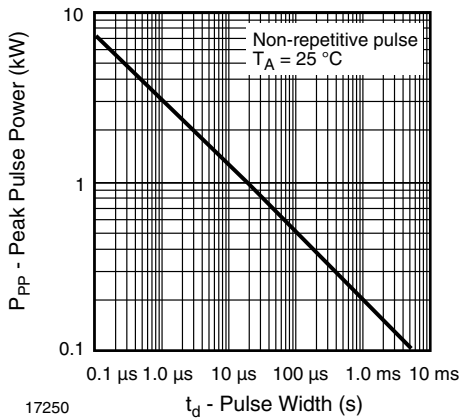

Fig. 3 - Peak Pulse Power Rating

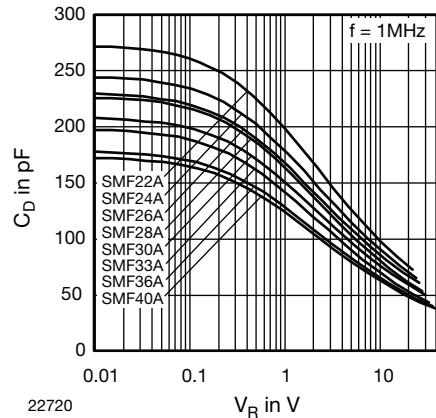

Fig. 6 - Typical Capacitance  $C_D$  vs. Reverse Voltage  $V_R$



# SMF5V0A to SMF58A

Vishay Semiconductors

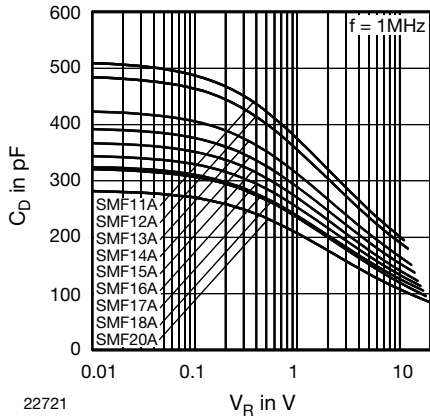

Fig. 7 - Typical Capacitance  $C_D$  vs. Reverse Voltage  $V_R$

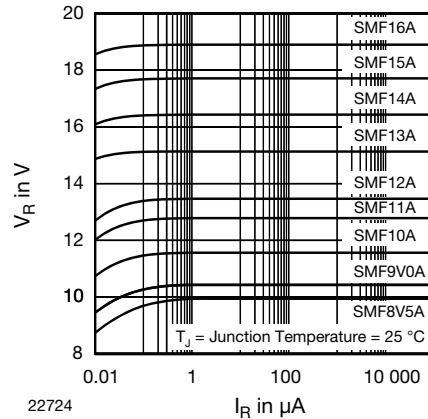

Fig. 10 - Typical Reverse Voltage  $V_R$  vs. Reverse Current  $I_R$

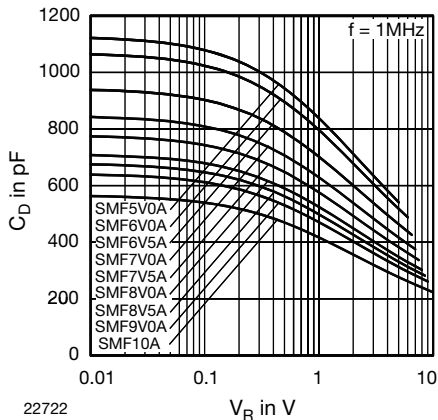

Fig. 8 - Typical Capacitance  $C_D$  vs. Reverse Voltage  $V_R$

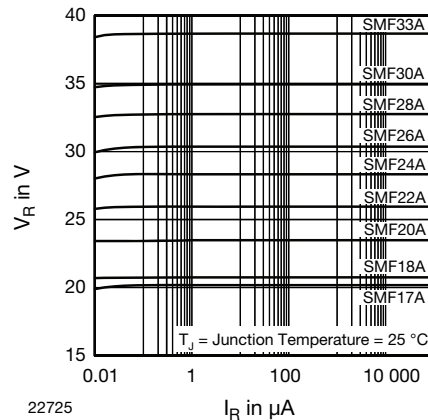

Fig. 11 - Typical Reverse Voltage  $V_R$  vs. Reverse Current  $I_R$

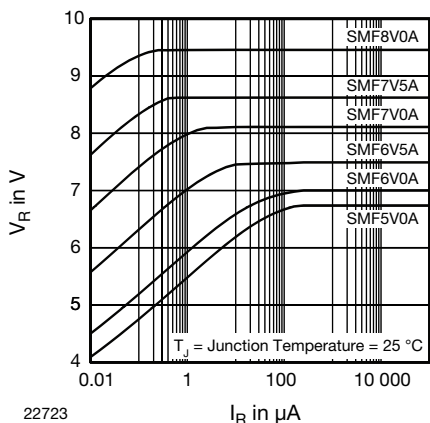

Fig. 9 - Typical Reverse Voltage  $V_R$  vs. Reverse Current  $I_R$

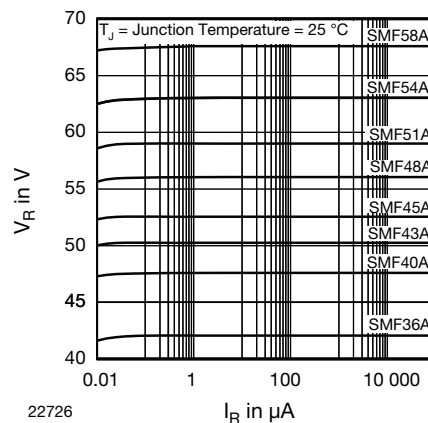

Fig. 12 - Typical Reverse Voltage  $V_R$  vs. Reverse Current  $I_R$



www.vishay.com

# SMF5V0A to SMF58A

Vishay Semiconductors

## PACKAGE DIMENSIONS in millimeters (inches): SMF (DO-219AB)

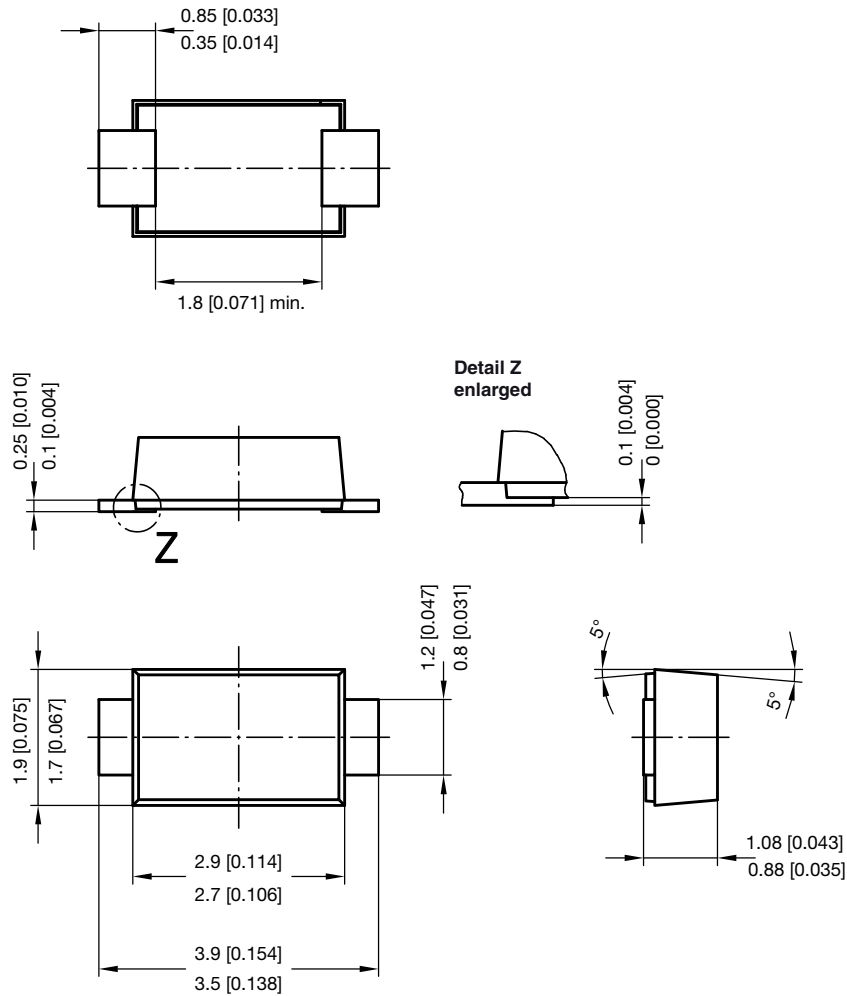

foot print recommendation:

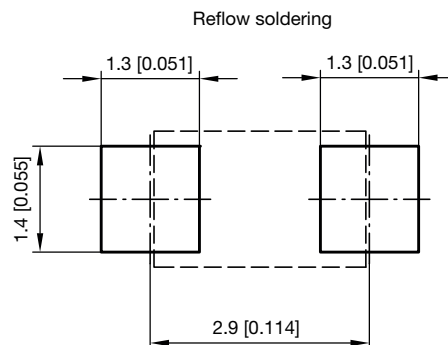

Created - Date: 15. February 2005  
 Rev. 6 - Date: 24.Feb.2021  
 Document no.: S8-V-3915.01-001 (4)  
 22989



**ORIENTATION IN CARRIER TAPE - SMF (DO-219AB)**

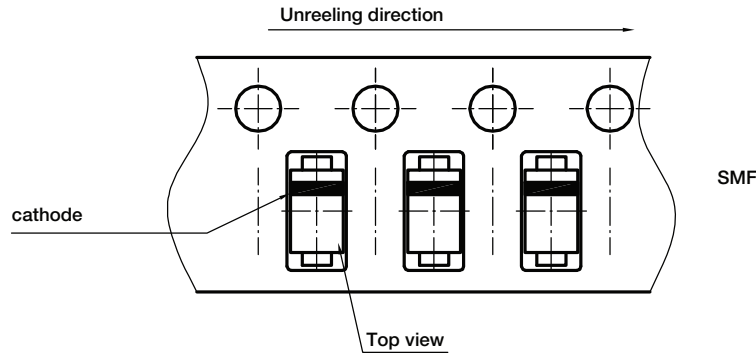

Document no.: S8-V-3717.02-003 (4)  
Created - Date: 09. Feb. 2010  
22670



## Disclaimer

ALL PRODUCT, PRODUCT SPECIFICATIONS AND DATA ARE SUBJECT TO CHANGE WITHOUT NOTICE TO IMPROVE RELIABILITY, FUNCTION OR DESIGN OR OTHERWISE.

Vishay Intertechnology, Inc., its affiliates, agents, and employees, and all persons acting on its or their behalf (collectively, "Vishay"), disclaim any and all liability for any errors, inaccuracies or incompleteness contained in any datasheet or in any other disclosure relating to any product.

Vishay makes no warranty, representation or guarantee regarding the suitability of the products for any particular purpose or the continuing production of any product. To the maximum extent permitted by applicable law, Vishay disclaims (i) any and all liability arising out of the application or use of any product, (ii) any and all liability, including without limitation special, consequential or incidental damages, and (iii) any and all implied warranties, including warranties of fitness for particular purpose, non-infringement and merchantability.

Statements regarding the suitability of products for certain types of applications are based on Vishay's knowledge of typical requirements that are often placed on Vishay products in generic applications. Such statements are not binding statements about the suitability of products for a particular application. It is the customer's responsibility to validate that a particular product with the properties described in the product specification is suitable for use in a particular application. Parameters provided in datasheets and / or specifications may vary in different applications and performance may vary over time. All operating parameters, including typical parameters, must be validated for each customer application by the customer's technical experts. Product specifications do not expand or otherwise modify Vishay's terms and conditions of purchase, including but not limited to the warranty expressed therein.

Hyperlinks included in this datasheet may direct users to third-party websites. These links are provided as a convenience and for informational purposes only. Inclusion of these hyperlinks does not constitute an endorsement or an approval by Vishay of any of the products, services or opinions of the corporation, organization or individual associated with the third-party website. Vishay disclaims any and all liability and bears no responsibility for the accuracy, legality or content of the third-party website or for that of subsequent links.

Vishay products are not designed for use in life-saving or life-sustaining applications or any application in which the failure of the Vishay product could result in personal injury or death unless specifically qualified in writing by Vishay. Customers using or selling Vishay products not expressly indicated for use in such applications do so at their own risk. Please contact authorized Vishay personnel to obtain written terms and conditions regarding products designed for such applications.

No license, express or implied, by estoppel or otherwise, to any intellectual property rights is granted by this document or by any conduct of Vishay. Product names and markings noted herein may be trademarks of their respective owners.

## OUR CERTIFICATE

DiGi provide top-quality products and perfect service for customer worldwide through standardization, technological innovation and continuous improvement. DiGi through third-party certification, we stricly control the quality of products and services. Welcome your RFQ to

Email: [Info@DiGi-Electronics.com](mailto:Info@DiGi-Electronics.com)



Tel: +00 852-30501935

RFQ Email: [Info@DiGi-Electronics.com](mailto:Info@DiGi-Electronics.com)

DiGi is a global authorized distributor of electronic components.