

01220088Z Datasheet

www.digi-electronics.com



<https://www.DiGi-Electronics.com>

DiGi Electronics Part Number	01220088Z-DG
Manufacturer	Littelfuse Inc.
Manufacturer Product Number	01220088Z
Description	FUSE CLIP CARTRIDGE 1KV 30A PCB
Detailed Description	Fuse Clip 30 A 1000V 1 Circuit Cartridge Through Hole

This model 01220088Z is available at DiGi Electronics.

DiGi Electronics offers a global database of semiconductor and electronic component datasheets.

We welcome your inquiries regarding pricing, lead time, or other product-related questions.

 [Request a Quote](#)

 [Datasheet Search](#)



Tel: +00 852-30501935

RFQ Email: Info@DiGi-Electronics.com

DiGi is a global authorized distributor of electronic components.

Purchase and inquiry

Manufacturer Product Number:

01220088Z

Series:

122

Mounting Type:

Through Hole

Current Rating (Amps):

30 A

Fuse Type:

Cartridge

Number of Circuits:

1

Orientation:

Horizontal

Contact Material:

Beryllium Copper

Manufacturer:

Littelfuse Inc.

Product Status:

Active

Fuse Size:

0.25" Dia (6.35mm)

For Use With/Related Products:

1/4" Dia Fuses

Fuseholder Type:

Clip

Voltage:

1000V

Termination Style:

PC Pin

Contact Finish:

Tin

Environmental & Export classification

RoHS Status:

ROHS3 Compliant

REACH Status:

REACH Unaffected

HTSUS:

8538.90.8180

Moisture Sensitivity Level (MSL):

Not Applicable

ECCN:

EAR99

102/122 Series Circuit Board Mount Fuse Clips for 1/4" Diameter Fuses

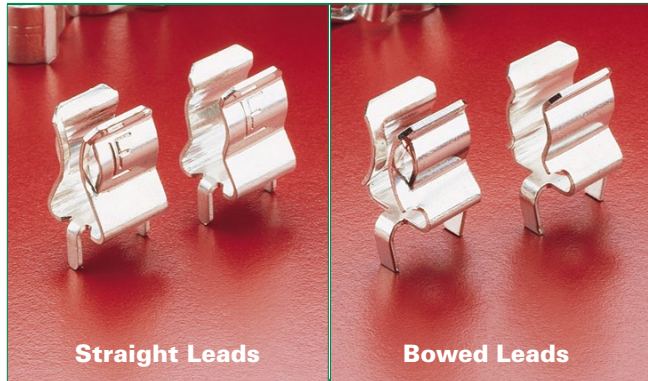

Agency Approval		
Agency	Agency File Number	
	102 Series	122 Series
	E14721	

Additional Information

**Datasheet
102 Series**

**Resources
102 Series**

**Samples
102 Series**

**Datasheet
122 Series**



**Resources
122 Series**

**Samples
122 Series**

Product Characteristics

	102 Series	122 Series
Compatible Fuse Size	1/4" Diameter Fuses 312, 313, 314, 326, 505, 506, 508 Series	
Current Level	15 amperes max	30 amperes max

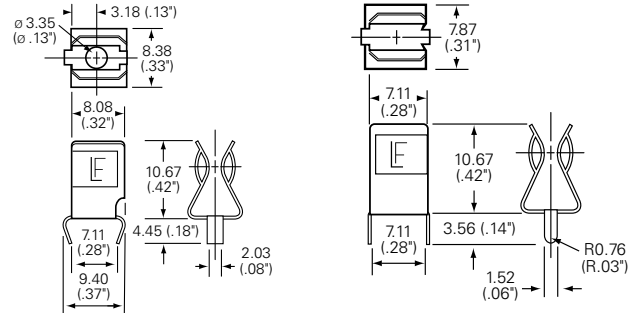
Product Dimensions



Bowed Leads for 102 series

Straight Leads for 102 and 122 Series

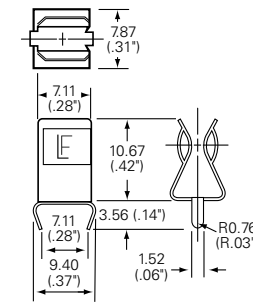

Bowed Leads for 122 series

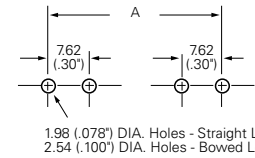

Recommended Mounting Dimensions

Nominal Fuse Length	"A" Length
5/8	.750
3/4	.875
7/8	1.000
1	1.125
1 1/16	1.187
1 1/4	1.347
1 7/16	1.562

Ordering Information

Ordering PN *	Catalog No.	Clip Material	Plating	Style	Packaging Available
Traditional Clips					
01020071	102 071	Spring Brass	Tin-plated	Ear	Z
01020074	102 074	Spring Brass	Tin-plated	Earless	Z
01020076	102 076	Spring Brass	Tin-plated	Ear	Z
01220055	122 055	Copper-Nickel Alloy	Tin-plated	Ear	Z
01220083	122 083	Beryllium Copper	Silver-plated	Ear	Z
01220087	122 087	Beryllium Copper	Silver-plated	Earless	Z
01220088	122 088	Beryllium Copper	Tin-plated	Ear	Z & ZR
01220093	122 093	Beryllium Copper	Tin-plated	Earless	Z
Bowed Tab Clips					
01020078	102 078	Spring Brass	Tin-plated	Earless	H & Z
01020079	102 079	Spring Brass	Tin-plated	Ear	Z
01220055Z-1	122 055	Copper-Nickel Alloy	Tin-plated	Ear	-
01220088Z-1	122 088	Beryllium Copper	Tin-plated	Ear	-

***Add Suffix to the Ordering PN for Packaging:**

"H" = Std. package 100 pcs per pack

"Z" = For bulk package

"ZR" = Tape and reel package, 300pcs

OUR CERTIFICATE

DiGi provide top-quality products and perfect service for customer worldwide through standardization, technological innovation and continuous improvement. DiGi through third-party certification, we strictly control the quality of products and services. Welcome your RFQ to

Email: Info@DiGi-Electronics.com



Tel: +00 852-30501935

RFQ Email: Info@DiGi-Electronics.com

DiGi is a global authorized distributor of electronic components.